

# PARKING AREAS

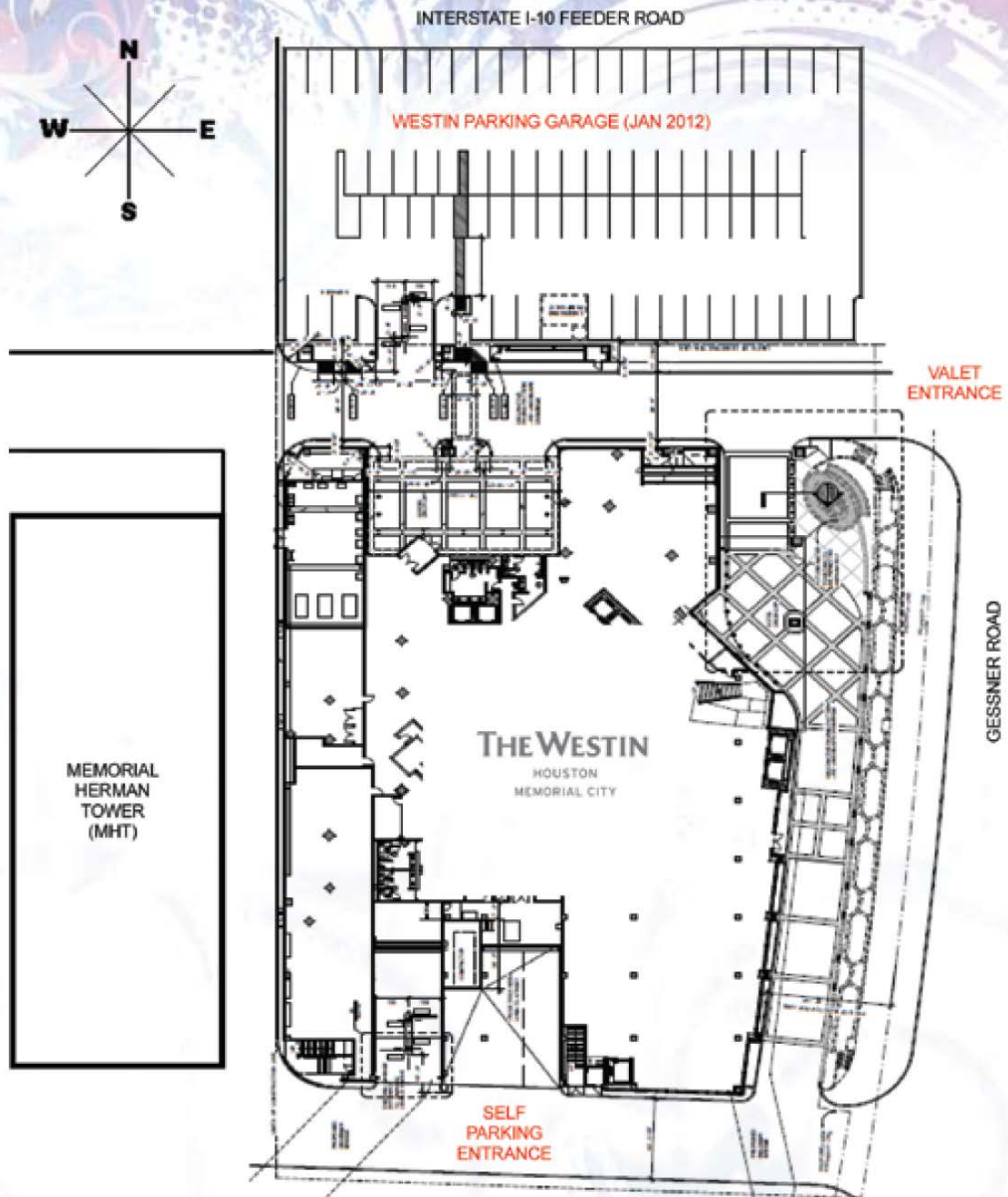

## Several parking areas are available for our guests:

1. Self Parking: pro-rated in the parking garage based on the amount of time spent at the hotel, with a maximum of \$12.00 for a 24 hour period.
2. Daily Valet Parking: \$13.00.
3. Overnight Valet Parking: \$19.00.
4. Complimentary parking across the street at the mall is also available but be sure to check with the hotel or mall security to avoid towing.

**Please refrain from using the marked Hospital parking lots or Hospital visitor areas.  
HSD, Inc. will not be responsible for any vehicles that are towed, vandalized or stolen.**